

SPECIFICATIONS

Features

- Work for most 3-wire/ 2-wire dimmer
- Compact size
- Low profile
- Constant Current Output
- Active Power Factor
- Class 2 compliance
- 5 Year Warranty

Wiring Diagram

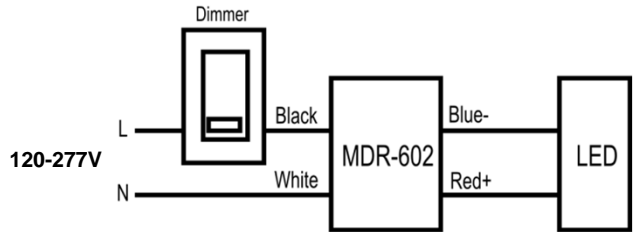

Mechanical and Thermal

Dimensions L3.74"XW1.536"XH1.103"
 Lead Wire Length 6" (Standard)
 Max. Case Operation Temp. 80°C

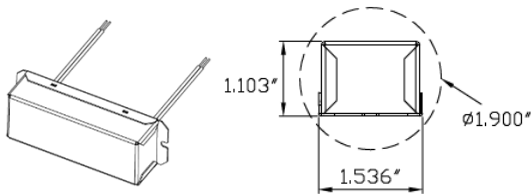

* Dimension in Inch

Protection

- Auto-reset electronic short circuit
- Overload protection
- Thermal protection
- Class 2

Environmental Specifications

- MTBF >100,000 hrs
- RoHS Compliant
- Lead Free SMT process
- Power Factor Correction / Low Load
- FCC Part 15 Class B compliant



Note –

1. UL file No. : Pending



Macron Associate Co. – Power Supply Team

NO.352, Peng-Yi Road, Taiping, Taichung, Taiwan 411

TEL: 886-4-22708357 FAX: 886-4-22767307 Email: macron@macrongroup.com

A0516

Input - specification

| | Units | Minimum | Typical | Maximum | Notes |
|----------------------------------|---|---------|---------|------------------------------|--|
| Input Voltage Range(Vin) | Vac | 108 | 120-277 | 304 | |
| Input Frequency Range | Hz | 50 | 60 | 63 | |
| Input Power | W | | | | |
| Power Factor(PF) | | 0.9 | >0.9 | | >80% Load |
| Input Current | A | - | - | 0.15A@120VAC 0.06A@277VAC | |
| Inrush Current | A | | | 4 A peak | According to IEC 60555 |
| Total Harmonics Distortion (THD) | | | | 20% | 1. At nominal input voltage and nominal LED voltage |
| | | | | | 2. Measure at full load |
| Efficiency | | - | >80% | - | Efficiency is measured after driver has thermally stabilized + full load |
| Isolation | Meet UL1310/UL8750 for class 2 isolation power supply | | | | |

Output - specification

| | Units | Minimum | Typical | Maximum | Notes |
|----------------------------|---|---------|---------|---------|---|
| Output Voltage(V out) | Vdc | 28 | | 37 | |
| Output Current(I out) | mA | | 350 | | |
| Output Current Tolerance | % | | ±3 | | |
| Output Ripple Current | <20% peak-to-peak of 350mA | | | | ≤20% pk-to-pk of the rated output current for all models with Vout max ≥ 32V |
| | | | | | ≤50% pk-to-pk of the rated output current for all models with Vout max ≤ 30V |
| | | | | | At nominal LED voltage and nominal input voltage without dimming |
| Dimming Range | % | 1% | | 100% | Please refer to Dimmer compatibility list |
| Start-up Time | ms | | 100 | | With nominal LED voltage and without dimmer attached |
| | | | 150 | | With nominal LED voltage, with an recommended dimmer attached(see dimmer compatibility list) and at the full dimming conduction angle |
| Operation Case Temperature | °C | -30 | | 80C | |
| Isolation | Meet UL1310/UL8750 for class 2 isolation power supply | | | | |

EMC / Protection / Compliance

| | | | | | |
|----------------------------|-------------------------------|--|--|--|--|
| Conducted and Radiated EMI | | FCC CFR Title 47 Part 15 Class B and EN55022(CISPR 22) Class B compliant | | | |
| Immunity Compliance | ESD (Electrostatic Discharge) | IEC61000-4-2 | 6 kV contact discharge, 8 kV air discharge, level 3 | | |
| | Electrical Fast Transient | IEC61000-4-4 | ±2 kV on AC power port for 1 minute, ±1kV on signal/control lines | | |
| | Surge | IEC61000-4-5 | ±1kV line to line/±2kV line to earth on AC power port, ±0.5kV for outdoor cables | | |
| Transient Protection | Ring Wave | | ANSI/IEEE c62.41-1-2002 & c62.41-2-2002 category A, 2.5kV ring wave | | |

THD of the driver VS Power Output (W) :

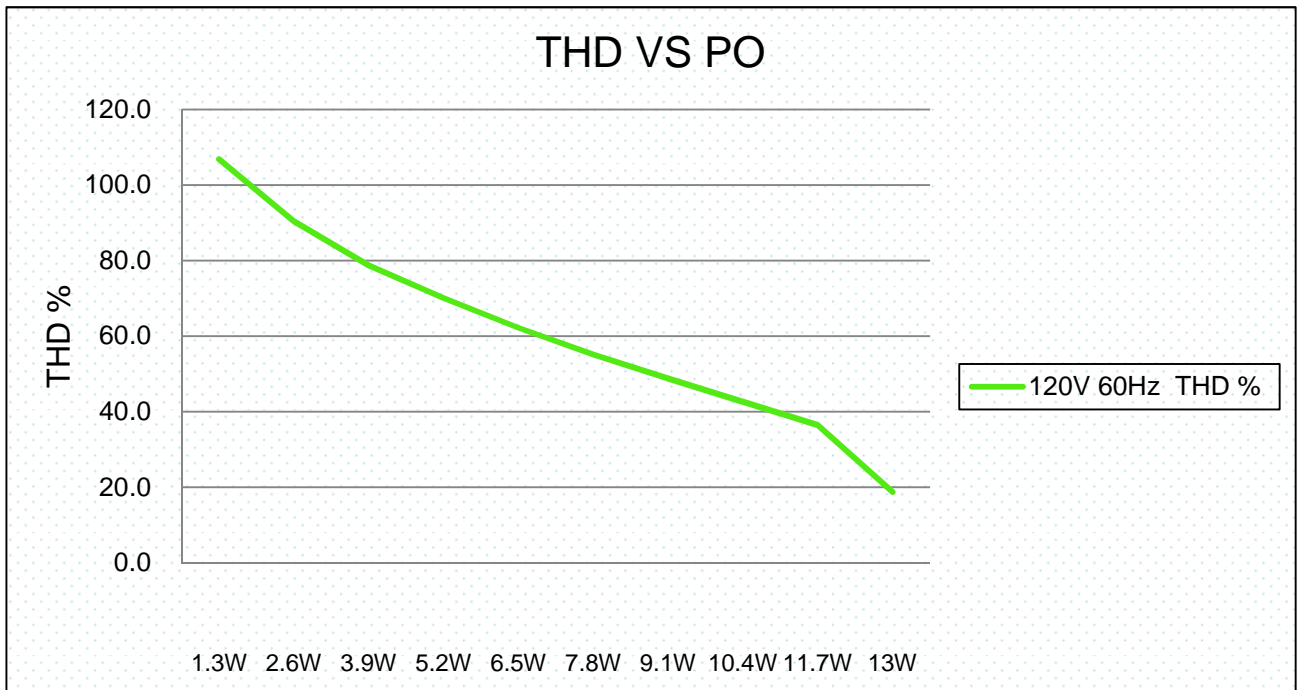

Efficiency of the driver VS Power Output (W) :

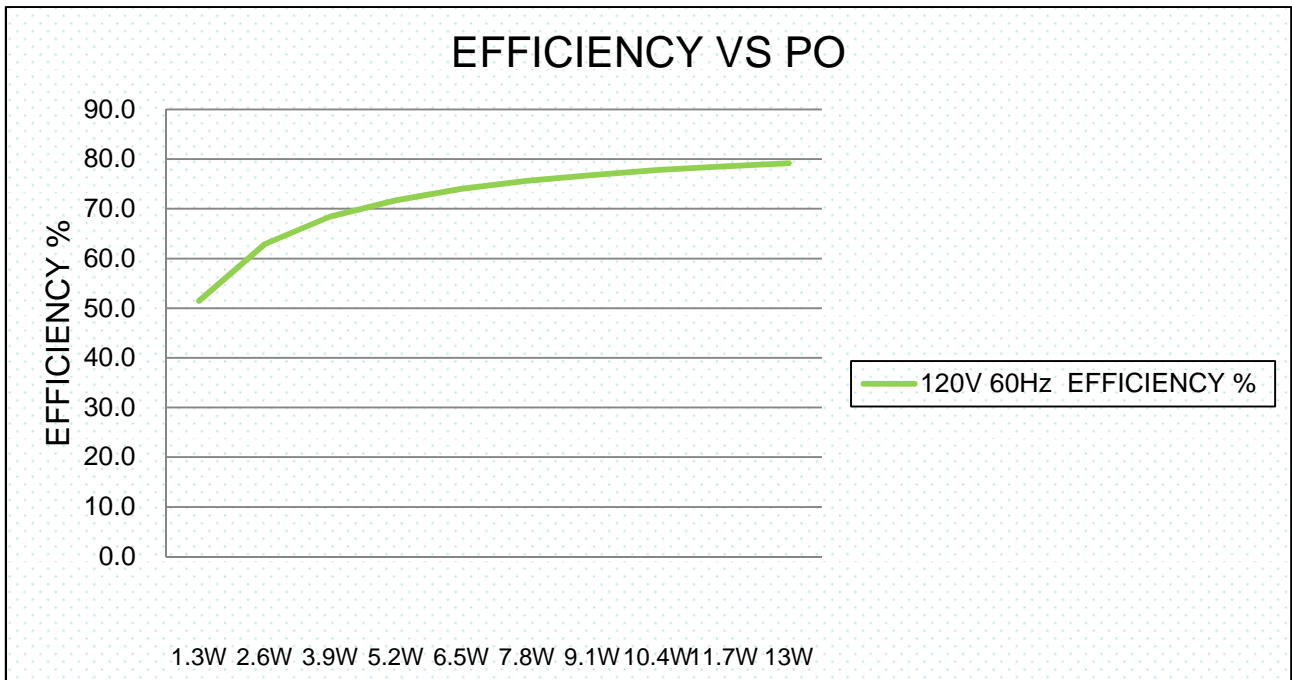

Macron Associate Co. – Power Supply Team

NO.352, Peng-Yi Road, Taiping, Taichung, Taiwan 411

TEL: 886-4-22708357 FAX: 886-4-22767307 Email: macron@macrongroup.com

A0516

Electrical Specifications

Efficiency of the driver VS Power Output (W) :

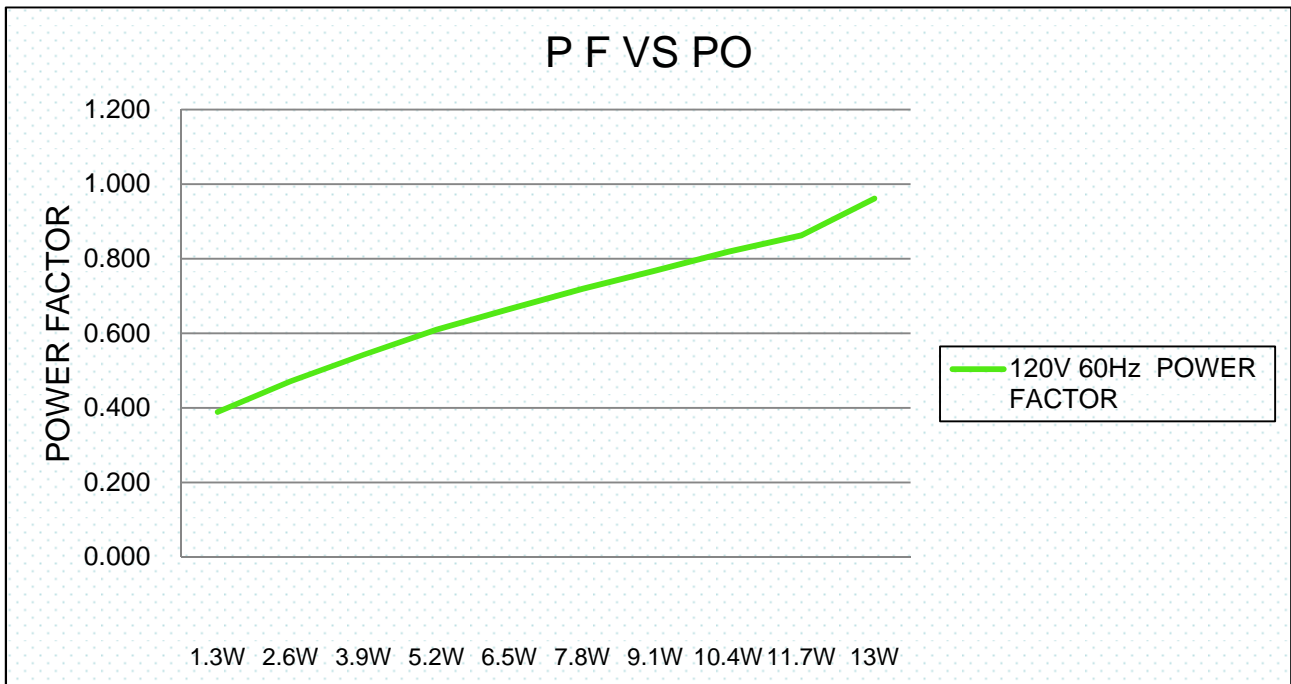

Macron Associate Co. – Power Supply Team

NO.352, Peng-Yi Road, Taiping, Taichung, Taiwan 411

TEL: 886-4-22708357 FAX: 886-4-22767307 Email: macron@macrongroup.com

A0516